

# Installation Guide

## Shower on Fixed Hook & Adjust Hook

### Suits Models:

30678 30679 30680 30681 35116 35117

### Important requirements:



Must be fitted in accordance with AS/NZS 3500 by qualified plumber



Mains 500kpa regulator must be fitted

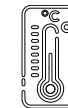

Maximum hot water temp. 65°C



Water lines must be flushed prior to connection



Only clean municipal water supply. No bore, dam or hard water without filtration & treatment

### Cleaning

Clean only with a soft microfiber or similar cloth and warm clean water. Ensure that the cloth is clean and free of any grit or chemical. Dry tap off with a soft clean cloth. Ensure that your tap is not subject to any chemicals, building grit or any type of abrasive or polish. For care of special finishes please visit our website.

### Maintenance

Aerators may need to be flushed from time to time if flow diminishes or stream pattern deteriorates. For Pegasi & Cascade mixers, use the aerator key provided to unscrew the aerator. You will notice a “castle” pattern around the edge of the aerator, the key engages with this allowing you to unscrew the insert easily. For Zeos models, use the aerator key to unscrew the aerator housing, you will then be able to pop the insert out the top of the housing. Rinse off the upper face of the insert with running water and gently brush clean with an old toothbrush to remove any debris before refitting the aerator.

## Shower on Fixed Hook

1. Ensure that the ½" water supply lug is not protruding from the wall more than 15mm. Remove any debris or tile glue from the lug, wind sufficient thread tape onto the lug.
2. Run a liberal amount of water into a bucket to rinse the lines.
3. Place a flange onto the back of the elbow and screw this onto the water supply lug until it screw back close to the tiles, then press the flange back against the tiles
4. Chose a suitable position for the fixed hook, mark the screw holes and drill 7mm holes.
5. Place a flange over the hook and fasten to the wall with the screws and plugs provided, note that the hook has a conical shaped clasp, ensure that the larger side is to the top.
6. Attach one end of the hose to the elbow and the other to the handshower
7. Test the system

## Shower on Adjustable Hook

1. Ensure that the ½" water supply lug is not protruding from the wall more than 15mm. Remove any debris or tile glue from the lug.
2. Run a liberal amount of water into a bucket to rinse the lines.
3. Fit the flange onto the water supply lug then wind on sufficient thread tape.
4. Thread the spigot onto the threaded lug until it is touching the flange
5. Press the shower bracket over the lug and fasten in place with the grub screw
6. Attach the hose to the bracket and the handshower.
7. Test the system.

### Shower on Adjustable Hook

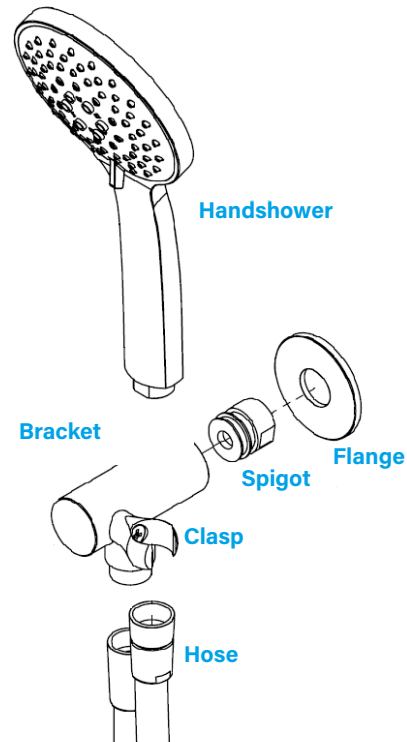

### Shower on Fixed Hook

